



**DW-HL678S**

Cascade system ULT freezer that consists of two stages cascade cooling technology with absolute hydrocarbon refrigerant, which are R290 and R170 as natural gas. The inverter compressors programmed to help energy saving under long period preservation or provide fast temperature recovery while frequently door open to maintain specimens liveness.



Energy consumption



Pulling down to -80°C

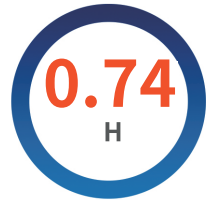

Temp. recovery after door opened for 1 min

\*Typical freezer data based on internal testing with freezer set point at -80°C and ambient temperature at 25°C.

**Features**



**Cascade system**  
Two stages cascade system



**Touch screen**  
10" LCD touch screen



**Hydrocarbon refrigerant**  
Environment-friendly natural gas



**Inverter technology**  
Two inverter compressors



**Vacuum insulation**  
VIP insulation foaming



**Alarms system**  
12 kinds of alarm functions

**Structure**

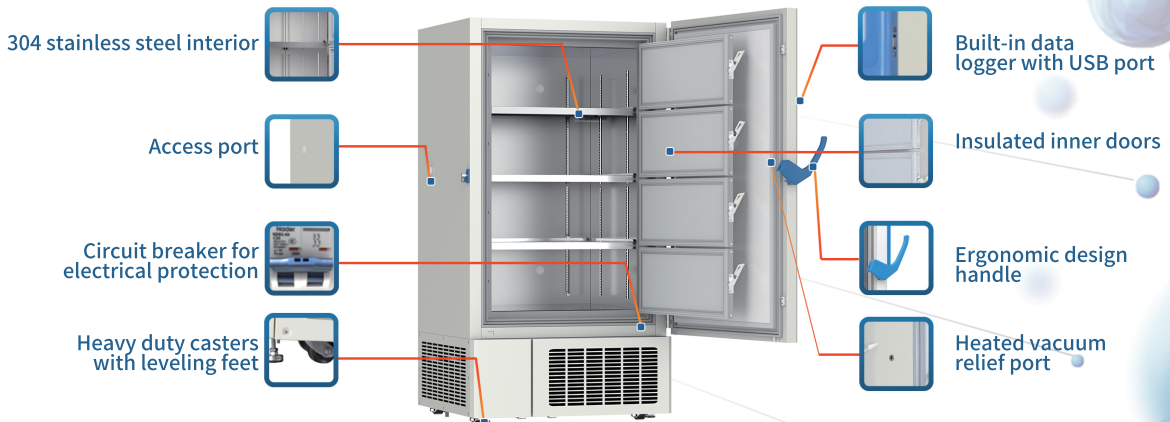

## Dimensions

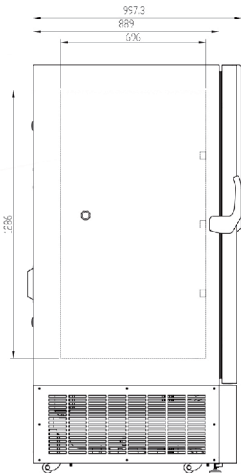
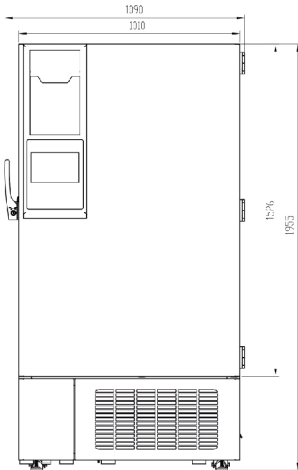

## Specification

<b>-86°C Ultra-low Temperature Freezer</b>	
Model	DW-HL678S
Capacity	678L/24Cu.Ft.
Internal Size (W*D*H) mm/inch	750*696*1286/29.53*27.4*50.63
External Size (W*D*H) mm/inch	1090*1025*1955/42.91*40.35*76.97
Package Size (W*D*H) mm/inch	1170*1150*2185/46.1*45.3*86.0
NW/GW (kgs)	308/360
<b>Performance</b>	
Temperature Range	-40~-86°C
Ambient Temperature	16-32°C
Cooling Performance	-86°C
Climate Class	N
Controller	Microprocessor
Display	10" HD Intelligent Touch Screen
<b>Refrigeration</b>	
Compressors	2pcs
Cooling Method	Direct Cooling
Defrost Mode	Manual
Refrigerants	High Stage: R290, Low Stage: R170
Insulation Thickness(mm)	D:100,L/R:130,B:130
<b>Construction</b>	
External Material	Cold Rolled Steel Sheet
Inner Material	Stainless Steel
Shelves	3(stainless steel)
Access Test Port	3pcs. Ø 25 mm
Casters	4+(2 balancing feet)
Data Logging/ Interval /Recording Time	USB/Record every 5 minutes / 10 years
Interface	Remote Alarm Contact, RS485
Backup Battery	Yes
<b>Alarms</b>	
Temperature	High/Low Temperature, High Ambient Temperature
Electrical	Power Failure, Low Battery, High-Stage High Temperature Alarm, Battery Level Detection Fault Alarm
System	Sensor Error, Main Board Communication Error, Door Ajar, High Pressure Alarm, Condenser Overheating Alarm
<b>Accessories</b>	
Freezer Rack Model	ZKL304-552B-CT
Freezer Rack/Box (Quantity)	20/500
<b>Electrical Data</b>	
Power Supply(V/Hz)	110-230V/50Hz-60Hz
Rated Current (A)	14.76A