

-86°C ULT freezer

Twincore Series:

One compressor disconnected And The Other Keeps The Machine Running at -70 Degrees.

Targeted Refrigeration • Fast Refrigeration
 Energy-saving & Environmentally Friendly
 Awarded with the Second Prize under State Technological Invention



Temp. uniformity



Pulling down to -80°C



Temp. recovery after door opened for 1 min

*Typical freezer data based on internal testing with freezer set point at -80°C and ambient temperature at 22°C.



DW-HL1008

Features



Industrial twin-compressor



Touch screen
7" LCD touch screen



Hydrocarbon refrigerant
Environment-friendly natural gas



CE certificate



Vacuum insulation
VIP insulation foaming



Alarms system
Multiple alarm functions

Structure

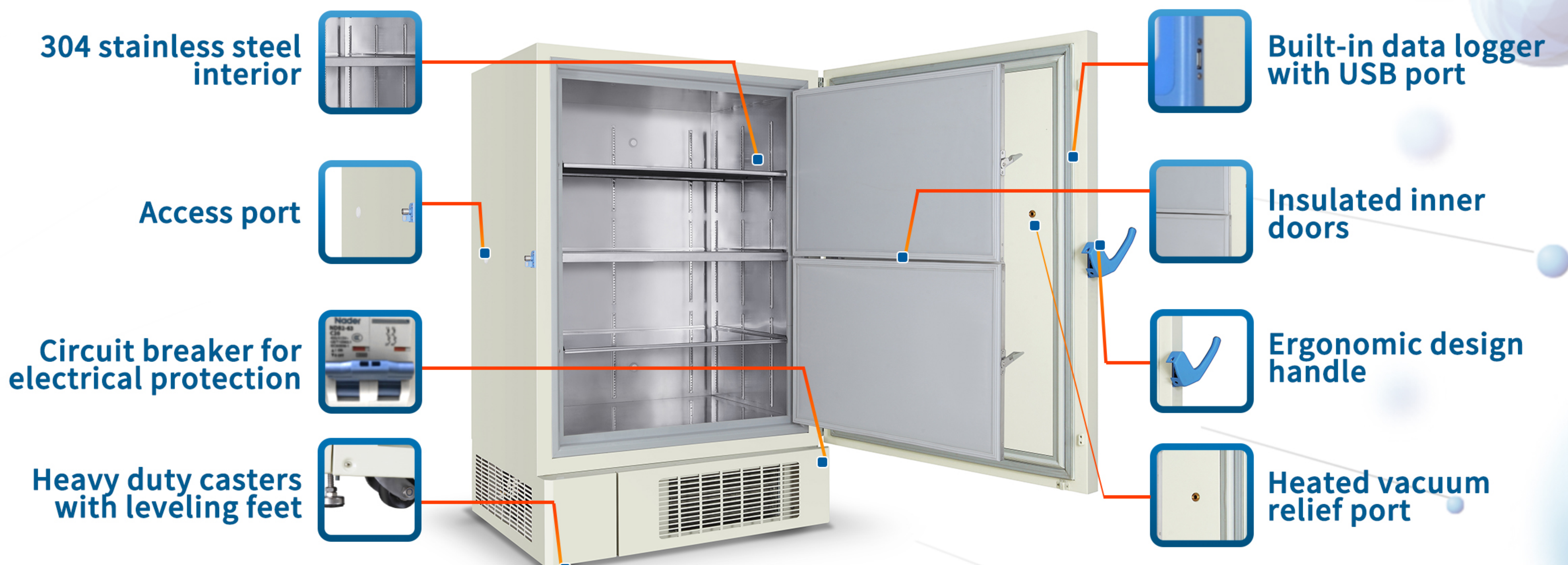

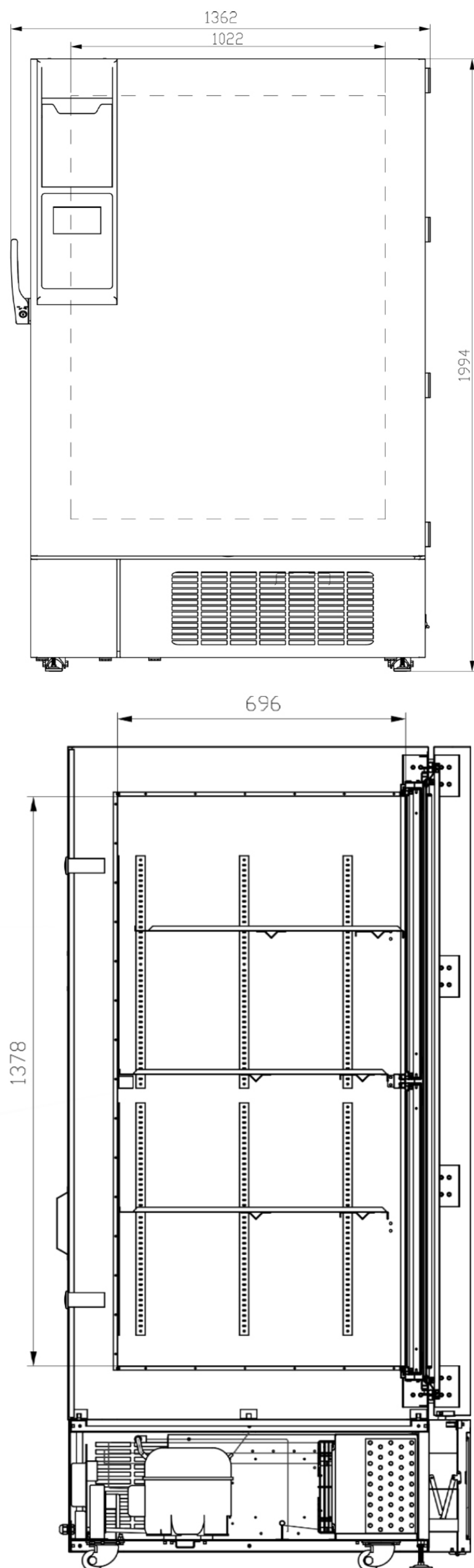

-86°C Ultra-low Temperature Freezer		
Model	DW-HL1008	
Capacity	1008L/35.6Cu.Ft.	
Internal Size (W*D*H) mm/Inch	1022*696*1378/40.2*27.4*54.3	
External Size (W*D*H) mm/Inch	1362*1025*1994/53.6*40.4*78.5	
Package Size (W*D*H) mm/Inch	1473*1155*2176/58.0*45.5*85.7	
NW/GW (kgs)	426/510	
Performance		
Temperature Range	-40~-86°C	
Ambient Temperature	16-32°C	
Cooling Performance	-86°C	
Climate Class	N	
Controller	Microprocessor	
Display	7" HD Intelligent Touch Screen	
Refrigeration		
Compressors	2pcs	
Cooling Method	Direct Cooling	
Defrost Mode	Manual	
Refrigerants	HC	Mixed
Insulation Thickness(mm)	D:109, L/R:130, B:120	
Construction		
External Material	Cold Rolled Steel Sheet	
Inner Material	Stainless Steel	
Shelves	3(stainless steel)	
Access Test Port	3pcs. Ø 25 mm	
Casters	4+(2 leveling feet)	
Data Logging/ Interval /Recording Time	USB/Record every 5 minutes / 10 years	
Interface	Remote Alarm Contact, RS485	
Backup Battery	Yes	
Alarms		
Temperature	High/Low Temperature, High Ambient Temperature, Condenser High Temperature Alarm	
Electrical	Power Failure, Low Battery, Sensor Error, Battery Power Detection Failure	
System	Data Communication Failure, Door Ajar	
Accessories		
Freezer Rack Model	ZKL304-552B-CT、ZKL304-652B-CT	
Freezer Rack/Box (Quantity)	28/770	
Electrical Data		
Power Supply(V/HZ)	220-240V/50Hz	220-240V/60Hz
Rated Current (A)	13.39A	13.0A